

Universal DMX-512/1990 USITT programmable controller

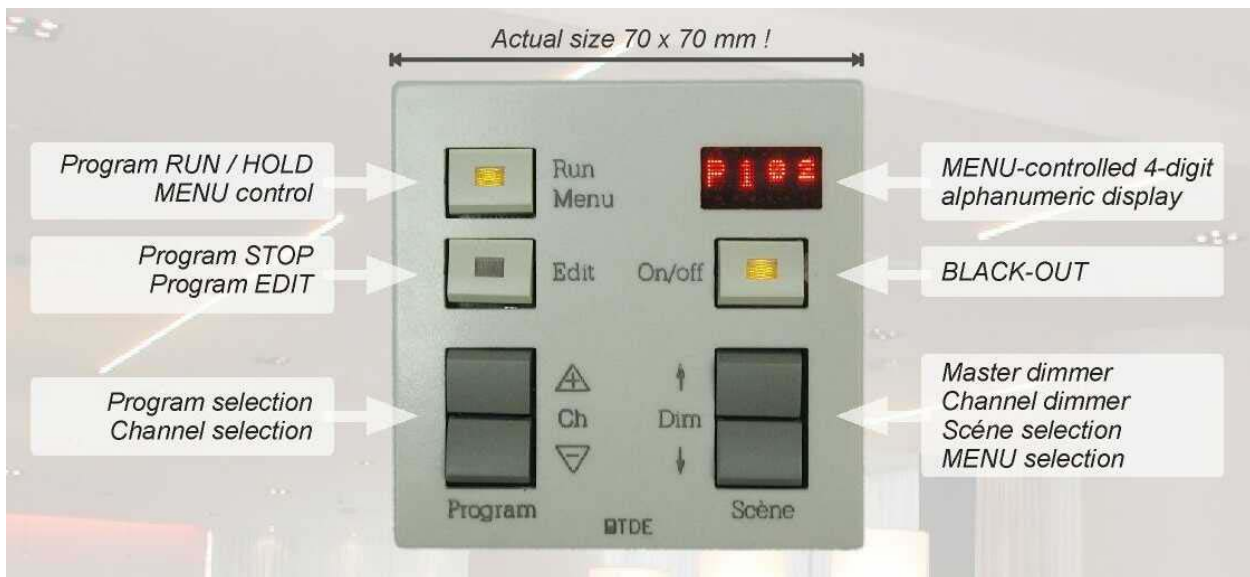

Key-features

- Very compact DMX-512/1990 programmable light controller
- Fits in every standard installation environment, even in combination with other standard switch materials as in environmental usages, very easy to install
- 8 DMX channels, 8 programs with a maximum of 16 scenes (totally 128 scene memory!)
- Programmable Cross-fade time between 0,1 second and 99 minutes for each step
- GRANDMASTER-dimmer and BLACK-OUT switches
- AUTO-RUN / WAKE-UP / LOCK with PIN-code functions
- MENU-controlled scrolling 4-digit alphanumeric LED-display (180° viewing angle)
- 7 switches, 3 with LED indication

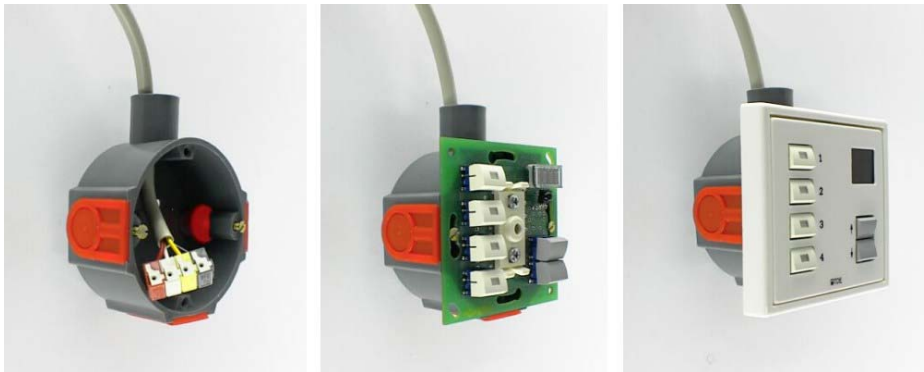

Dimensions: 70 x 70 x 25 mm (L x B x D), dimensions without mounting frame
80 x 80 x 25 mm (L x B x D), dimensions including mounting frame

Power Supply: 8...20 VDC, may be any (un)stabilized power supply
Current: 30 mA (with maximum display intensity)

Connections:	PIN-1 [BLACK]	0 Volt	Ground / Common
	PIN-2 [YELLOW]	DATA+	DMX-512/1990 data +
	PIN-3 [WHIT]	DATA-	DMX-512/1990 data -
	PIN-4 [RED]	REF	Power supply 8...20 Volt DC
			May be any (un)stabilized power supply

The connection terminal is removable. Please use massive wiring cable (4 x 0,8mm² maximum).

Function keys:

- [Run / Menu] Function select
- [Edit] Edit scene and scene programming
- [On/off] Blackout
- [+] / [-] Program and channel selection
- [UP] / [DOWN] Scene selection and master dimmer

[Run/Menu] ■ Function select

Press and hold [Run / Menu] until the wanted function is displayed, then release to activate.

- < RUN > RUN-mode Start running the selected program (start from STEP-1)
- < ZONE > Zone-mode Channel-edit without any programming (temporary mode)
- < MENU > Menu-mode SUB-Menu selection

Use [UP] / [DOWN] to select, [EDIT] to select or enter function

- <LOCK> Programmable LOCK-code (use grey keys to enter 4-digit lockcode)
- <WAKE> Programmable wake-up and auto-start functions
- <DISP> Display brightness control (from 1...15, where 15 is max. brightness)
- <DALL> Delete all storage (program) memory
- <EXIT> Menu-exit (press [Edit] to exit to scene-mode)

- While running a program you can hold & resume the current program by shortly pressing [RUN/MENU].
- While running a program use [Edit] to exit the selected program and switchback to scene-mode
- While running a program you can dim the total output by pressing [UP] or [DOWN] (Master dimmer function)
- While running a program you can change directly to other programs by pressing [+] or [-]

[Edit] ■ Edit scene and scene programming

Press and hold [Edit] until the wanted function is displayed, then release to activate.

- < PROG > Programming scenes and programs (including scene-copy mode)
- < SPEED > Programming the cross-fade time (0,1 seconds ... 99 minutes)
- < LAST > Programming the current step as last step in a selected program
- <DELETE> Deletes selected program, program length and speed and set to default

- While running a program use [Edit] to exit the selected program and switchback to scene-mode

[+] / [-]

- RUN-mode: Program selection (select other programs while running)
- PROGRAM-mode: Channel selection (select 1 of the 8 DMX-channels: C1...C8)

[UP] / [DOWN]

- RUN-mode: Dimmer function (master dimmer function)
- PROGRAM-mode: Scene selection (select scenes or copy scenes into other programs)
- Menu-mode: Menu selection

Programming:

1. **Select with [+] / [-] a desired program and with [UP] / [DOWN] the first step to program**
The display shows for instance [P1⁰¹]. (Program 1, Step 1)
2. **Press and hold the [Edit]-key till the displays shows the text [PROG], then release to activate**
The display shows the text [C1^{OFF}]. (C1 = channel-1, ^{OFF} = brightness)
[C1] ... [C8] = channel 1 ... 8
3. **Adjust the color scène with [+] / [-] for channel selection and [UP] / [DOWN] for brightness**
With [+] / [-] you can select the channels, for instance C1 = RED, C2 = GREEN, C3 = BLUE
With [UP] / [DOWN] you can control the brightness of the selected channel (0...100%)

Repeat Step 3 till all channels are adjusted and the desired color scene is created

4. **Press [Edit] and select with [UP] / [DOWN] keys the step where the scene has to be programmed**
The displays shows for instance [P1⁰¹]. (The display is flashing)
After the first step is programmed the display automatically shows the next step to be programmed.
If you want to copy a scene to another step or program, you can select them with the [UP] / [DOWN] and [+] / [-] keys
5. **Press [Edit] again to store the scène in the selected step**
The scène is stored in the selected step (The display stops flashing)

Repeat step 2 ... 5 for every step you want to program.

At this point the scène programming is done. Next we have to set the program length and fade speed

After this the programming is done. With the [UP] / [DOWN] keys you can check the entire program by stepping through the program and checking the outputs.

Programming the fade speed:

6. **Press and hold [Edit] till the display shows the text [SPEED], then release to activate**
The display shows the text [^{0,1} S] (^{0,1} = amount, S = seconds)
With the [UP] / [DOWN] keys you can set the fade time
The fade time is adjustable in 3 ranges

1:	0,1 ... 9,9 seconds	[^{0,1} S] .. [^{9,9} S]
2:	10 ... 59 seconds	[¹⁰ S] .. [⁵⁹ S]
3:	1 ... 99 minutes	[⁰¹ M] .. [⁹⁹ M]

For every program you have to adjust the fade time
7. **Press [Edit] again to store the fade time in the selected program**
The fade time is stored in the selected program

Adjust the program length:

8. **Select with [UP] / [DOWN] the last step in the program**
The display shows for instance [P1⁰⁶]. (Program 1, Step 6)
9. **Press and hold [Edit] till the display shows the text [LAST], then release to activate**
After releasing the button the display will show the text [LAST STEP = P1⁰⁶].
The selected step is now programmed as last step in the program.

P.S. For static color scène programming you may set the program length to the first step of a program.

Program delete

10. Press and hold [Edit] until the display shows [DELETE], then release to activate
After releasing the button the display shows: [DEL?]
11. Press [UP] to select the option [YES] to delete the selected program
With [UP] / [DOWN] you can select the options [YES] or [NO]
12. Press [Edit] to confirm deleting the selected program
When a program is deleted also the fade time is set to 0,1 seconds and LAST-STEP is reset to 1

Program RUN / HOLD & RESUME

13. Press shortly [Run / Menu] to start a selected program
The selected program starts running [Run / Menu]-button flashes, display shows: [RUN]

While a program is running you can change to other programs using the [+] / [-] buttons and change the total brightness (MASTER dimmer function) by using the [UP] / [DOWN] buttons.
14. Press [Run / Menu] to hold and freezes the output
The display shows the text [HOLD] [Run / Menu]-button stops flashing to indicate hold-mode
The output freezes till you press [Run / Menu] again
15. Press [Run / Menu] to resume the program
The program resume starting [Run / Menu]-button start flashing again

Program STOP and switchback to [scene]-mode

16. Press [EDIT] to stop a running program and to switchback to the [SCENE]-mode
The display now shows the current step of the selected program, for instance: [P1⁰³].

Scène and program dimming

While a program is running you can change the total output brightness using [UP] / [DOWN]

17. Press [UP] / [DOWN] to dim the selected program or scène (MASTER dimmer function)
While pressing the [UP] / [DOWN] buttons the displays shows the text [M: ^{xx}].
[^{xx}] is the relative intensity in % of the total brightness [OFF, 1..99% en ON]

TDE light-tech policy is one of continued development and we reserve the right to alter software and hardware specifications at any time without prior notice.

If you have any questions about this product don't hesitate to contact us or your local dealer.

TDE light-tech vof
Verrijn Stuartweg 11-A
1112 AW in Diemen
The Netherlands

tel: +31(0)20-6973849
fax: +31(0)20-6971775
e-mail: info@dimmer.nl
http: www.dimmer.nl